

**advanced FLOW engineering** Quantum Air Intake

**Instruction Manual** P/N: 53-10016D / 53-10016R

Make: **Ford** Model: **F-250/F-350/F-450/F-550** Year: **2008-2010** Engine: **V8-6.4L (td) Power Stroke**



- Please read the entire instruction manual before proceeding.
- Ensure all components listed are present.
- If you are missing any of the components, call customer support at 951-493-7100.
- Ensure you have all necessary tools before proceeding.
- Do not attempt to work on your vehicle when the engine is hot.
- Disconnect the negative battery terminal before proceeding.
- Retain factory parts for future use.

Label	Qty.	Description	Part Number
A1	1	Air Filter (Pro DRY S)	21-90098
A2	1	Air Filter (Pro 5R)	23-91129
B	1	Tube	05-5310016B1
C	1	Housing	05-5310016B2
D	1	Coupling, Silicone Bellow	05-01457
E	1	Coupling, Silicone Reducer	05-01505
F	2	Screw, Torx: M4	03-50490
G	1	Clamp, #048	03-50007
H	1	Clamp, #052	03-50008
I	1	Clamp, #072	03-50010
J	1	Clamp, #080	03-50011
K	1	Grommet	03-50139
L	1	Fitting, Vent Tube	03-50178
M	1	Clamp, Mini	03-50023

**Installation will require the following tools:**

8mm nut driver, T-20 Torx, Phillips #3 screwdriver and flat head screwdriver.

**Emissions Disclaimer:** This product is not currently CARB exempt and is not available for purchase in California or for use on any vehicle registered with the California Department of Motor Vehicles.

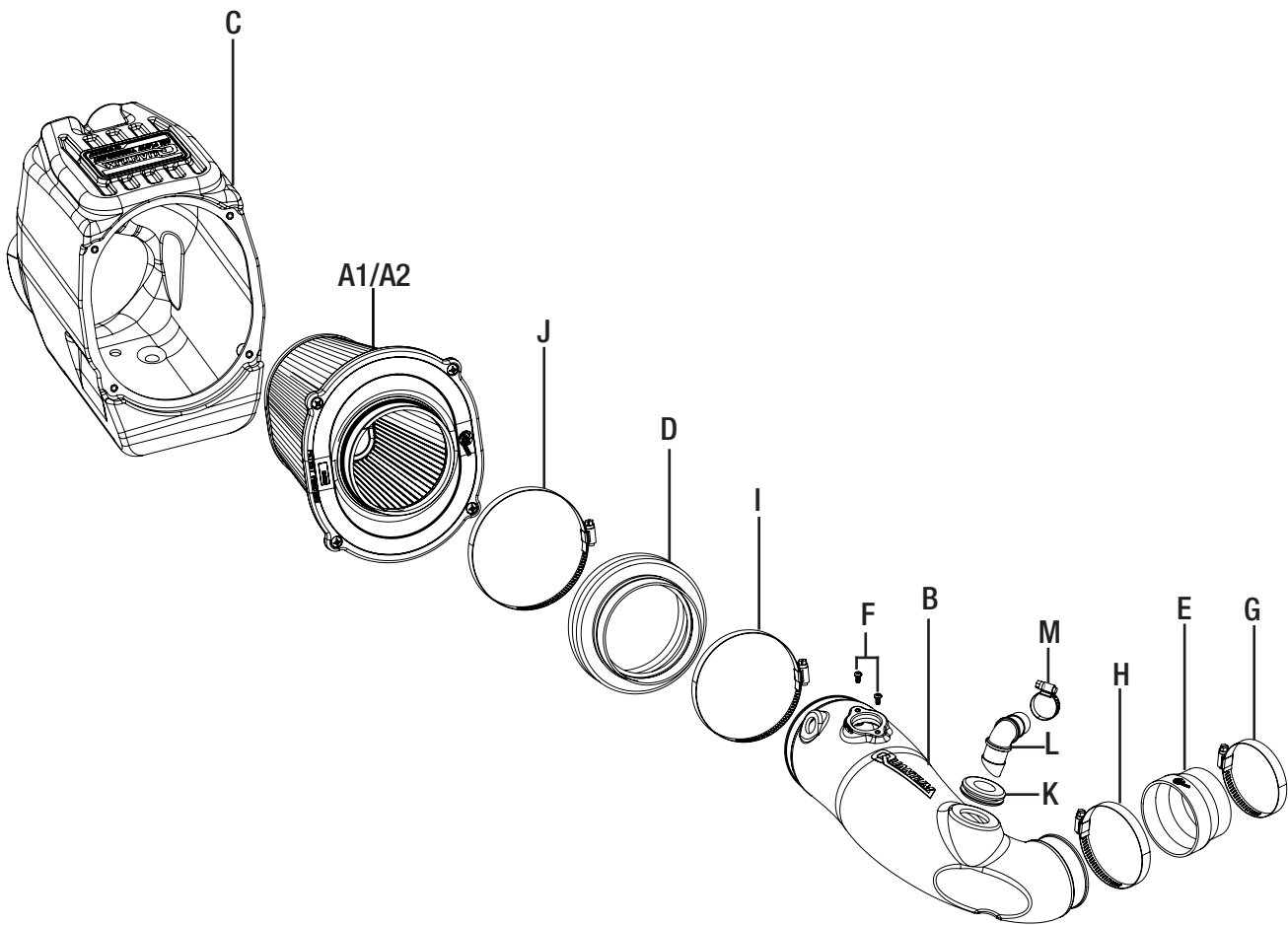

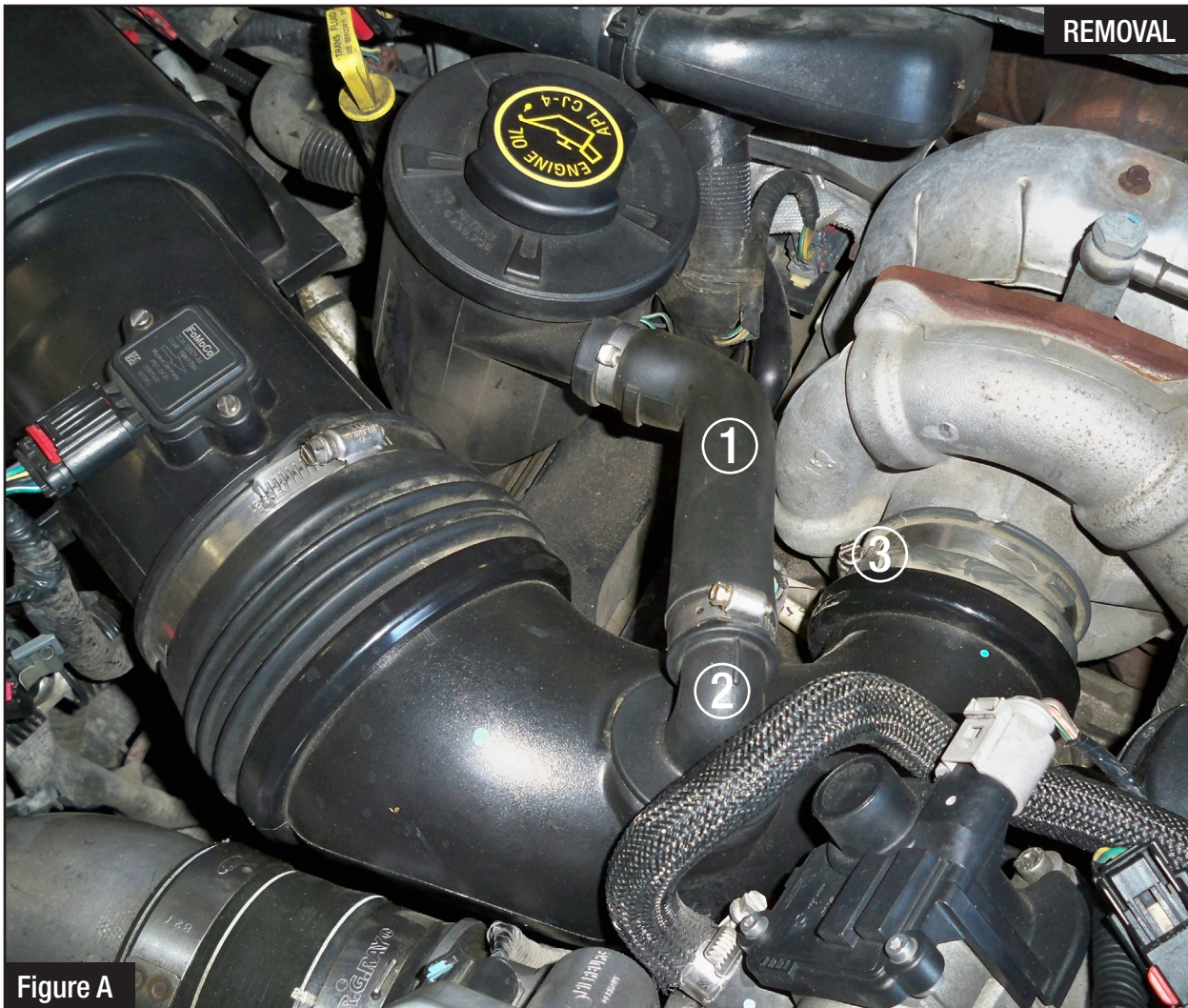
**Figure A****Refer to Figure A for Steps 1-2**

Step 1: Disconnect the crankcase vent oil separator hose (1) from the intake fitting (2) by prying the clamp open with a flat head screwdriver and discard the clamp.

Step 2: Using an 8mm nut driver, loosen the clamp (3) at the turbo.



Figure B

### **Refer to Figure B for Steps 3-5**

Step 3: Disconnect the filter minder (4) and the Mass Air Flow (MAF) sensor (5) connectors.

Step 4: Unclip the two latches (6) from the upper section of the housing.

Step 5: Remove the upper section of the housing.



**Refer to Figure C for Steps 6-8**

Step 6: Remove the air filter (7).

Step 7: Remove the intake tube assembly (8).

Step 8: Pull up on the lower section of the housing (9) to remove it from the support bracket grommets.

**Figure D****Refer to Figure D for Steps 9-10**

Step 9: Slide the aFe POWER filter into the aFe POWER housing. Install the aFe POWER filter using a #3 Phillips screwdriver. Tighten all four screws.

Step 10: Install the supplied bellows coupling (10) onto the air filter using the supplied #80 clamp (11). Tighten the clamp.



Figure E

**Refer to Figure E for Steps 11-13**

Step 11: Remove the filter minder and grommet (12) from the factory intake tube assembly and install them onto the aFe POWER intake tube.

Step 12: Using a T20 Torx driver, remove the MAF sensor (13) from the factory intake tube assembly and install it onto the aFe POWER intake tube using the two supplied M4 screws.

Step 13: Install the supplied rubber grommet and vent fitting (14) onto the aFe POWER intake tube.





Figure F

**Refer to Figure F for Step 14**

Step 14: Install the aFe POWER housing assembly (15) into the vehicle while inserting the vent hose (16) into the aFe POWER housing assembly. Make sure the housing pins go into the mounting bracket grommets.

**Figure G****Refer to Figure G for Steps 15-16**

Step 15: Install the supplied silicone reducer coupling (17) onto the aFe POWER intake tube with the supplied #52 clamp (18). Tighten the clamp.

Step 16: Place the provided #48 clamp (19) onto the reducer coupling and the #72 (20) clamp onto the filter coupling.



Figure H

### **Refer to Figure H for Steps 17-20**

Step 17: Slide the aFe POWER intake tube into the turbo inlet, then into the coupling at the filter. Tighten all the clamps with an 8mm nut driver.

Step 18: Slide the supplied mini clamp (21) onto the crankcase vent hose.

Step 19: Install the crankcase vent hose (22) into the vent fitting (23) and secure it with the mini clamp.

Step 20: Reconnect the MAF sensor (24) and the filter minder (25). Check all the components are tight and secure. Your installation is now complete. Thank you for choosing aFe POWER!

**NOTE: Check all clamps and connectors after 100-200 miles.**



Page left blank intentionally

Page left blank intentionally



Pro DRY S Air Filter



P/N: 21-90098

Pro 5R Air Filter



P/N: 23-91129

Pro DRY S Restore Kit



P/N: 90-59999

Blue Squeeze Restore Kit



P/N: 90-50501

Intercooler



P/N: 46-20071

Turbo Downpipe



P/N: 49-43025

Downpipe Back Exhaust

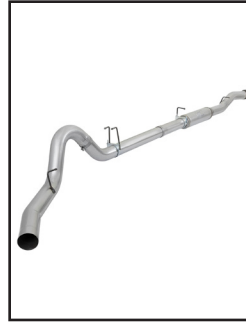

P/N: 49-03040-1

DPF-Back Exhaust



P/N: 49-43054-B (Bik. Tip)  
49-43054-P (Pol. Tip)

SCORCHER BLUE Tune



P/N: 77-63001

DFS Fuel System



P/N: 42-13031 (Full-Time)  
42-13032 (Part-Time)

Header Up-Pipes



P/N: 49-33016

Rear Differential Cover



P/N: 46-70022-WL (w/ Oil)

To purchase any of the items above, view airflow charts, dyno graphs, photos, and video; please go to [aFepower.com](http://aFepower.com).

# Warranty

## General Terms:

- aFe warrants their products to be free from manufacturer's defects due to workmanship and material.
- This warranty applies only to the original purchaser of the product and is non-transferrable.
- Proof of purchase of the aFe product is required for all warranty claims.
- Warranty is valid provided aFe instructions for installation and/or cleaning were properly followed.
- Proper maintenance with regular inspections of product is required to insure warranty coverage.
- Damage due to improper installation, abuse, unauthorized repair or alteration is not warranted.
- Incidental or consequential damages or cost, including installation and removal of part, incurred due to failure of aFe product is not covered under this warranty.
- All warranty is limited to the repair and/or replacement of the aFe part. To request Return Goods Authorization ("RGA"), email [RGA@afepower.com](mailto:RGA@afepower.com) or call (951)493-7100. Upon receipt of the RGA, you must return the product to the address provided in the RGA, freight prepaid and accompanied with a dated proof of purchase and the RGA. Upon receipt of the defective product and upon verification of proof of purchase, aFe will either repair or replace the defective product within a reasonable time, not to exceed thirty days.

<b>Product Category</b>	<b>P/N Prefix</b>	<b>Warranty duration</b>
Direct OE Replacement Filters	10, 11, 30, 31, 71, 73	Life of the vehicle
Racing Filters	18	1 year
Universal	21, 23, 24, 72	2 years
Air Intake Systems	50, 51, 53, 54, 55, 56, 57, 75	2 years
Exhaust Systems	49	2 years
Intercoolers & Intercooler Tubes	46-2	2 years
Intake Manifolds	46-1	2 years
Differential Cover	46-7	Life of the vehicle
Exhaust Manifolds	46	2 years
Throttle Body Spacers	46-3	2 years
Fluid Filters	44	90 days
Pre-Filters	28	2 years
Heavy Duty OE Replacement	70	2 years
PowerSports OE Replacement	81, 87	2 years
PowerSports Intake Systems	85	2 years

No other warranty expressed or implied applies nor is any person or advanced FLOW engineering authorized to assume any other warranty. Some States do not allow the exclusion or limitation of incidental or consequential damages or do not allow limitations on how long an implied warranty lasts, so the above limitations or exclusions may not apply to you. This warranty gives you specific legal rights, and you may also have other rights which vary from State to State.

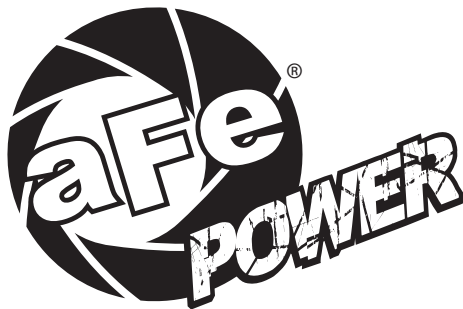

**advanced FLOW engineering, inc.**  
252 Granite Street Corona, CA 92879  
TEL: 951.493.7100 • TECH: 951.493.7134  
E-Mail: [Tech@aFepower.com](mailto:Tech@aFepower.com)