



INTAKE SYSTEMS FOR VEHICLES LISTED ARE 50 STATE LEGAL. SEE KNFILTERS.COM FOR CARB STATUS ON EACH PART FOR A SPECIFIC VEHICLE.

# INSTALLATION INSTRUCTIONS

**57-1531**  
**CHRYSLER**  
**2003-05 PT Cruiser**  
**L4-2.4L TURBO**

**PARTS LIST:**

	Description	Qty.	Part #
A	Hose Clamp #36	2	08530
B	Silicone Hose	1	08405
C	3/8" x 12" Silicone Hose	1	08412
D	Vent 90 deg. Plastic Barbed	1	08121
E	Grommet	2	08100
F	Intake Tube	1	087083
G	6mm - 1.00 x 16mm Bolt	1	07703
H	6mm Wave Washer	1	08174
I	1/4" Flat Washer	1	08275
J	Bracket	1	07168
K	5/16" Flat Washer	1	08276
L	8mm Wave Washer	1	08239
M	8mm - 1.25 x 16mm Bolt	1	07844
N	Filter Adapter	1	088005-1
O	Hose Clamp #64	1	08648
P	Air Filter	1	RP-4660
Q	Edge Trim 61"L	1	102492
R	Heat Shield	1	074004
S	3/8" - 16 x 1.250" Bolt	2	07779
T	3/8" Flat Washer	2	08134
U	Rubber Nut Insert	2	08163

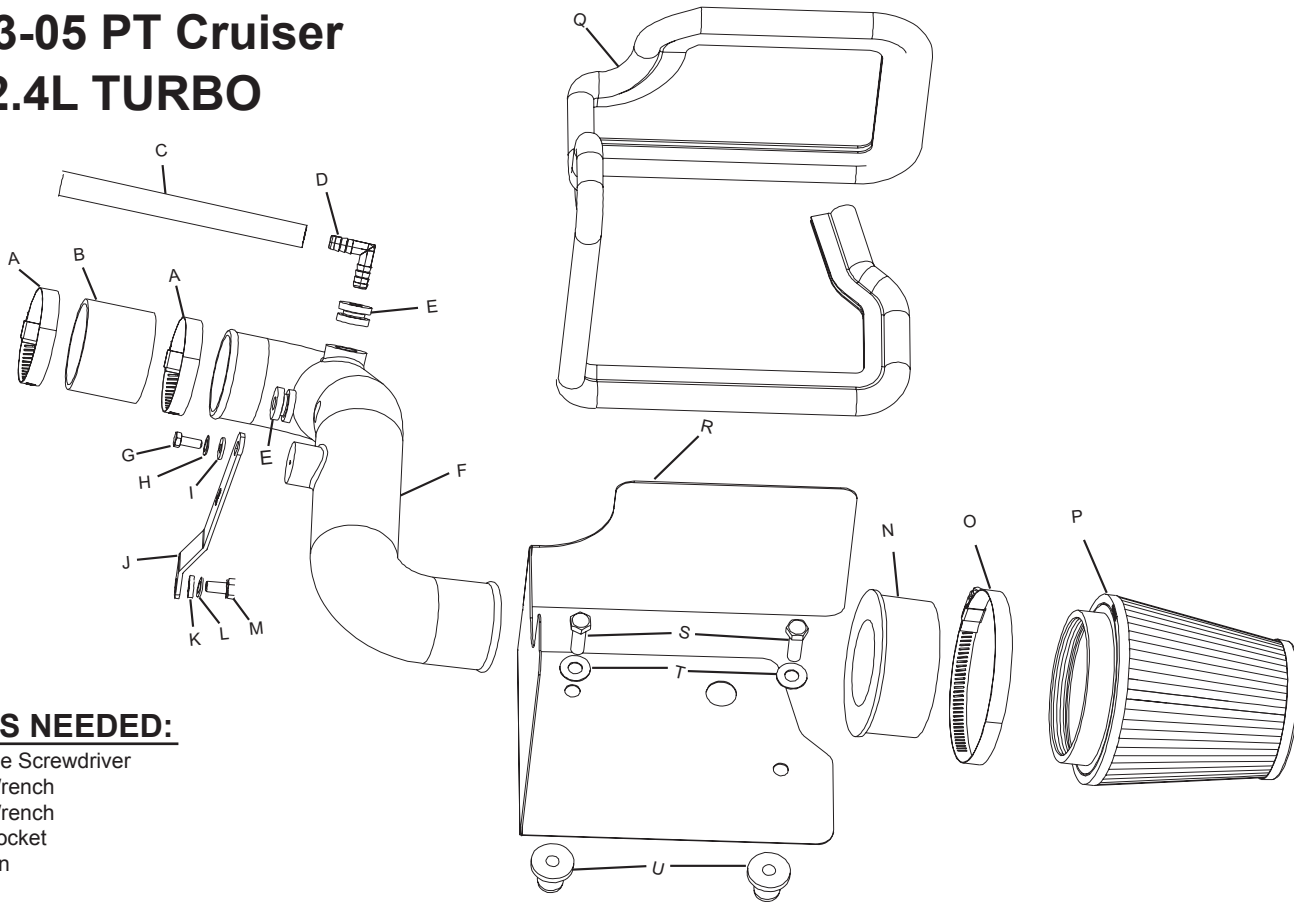

**TOOLS NEEDED:**

- Flat Blade Screwdriver
- 10mm Wrench
- 13mm Wrench
- 14mm Socket
- Extension
- Ratchet

**NOTE: FAILURE TO FOLLOW INSTALLATION INSTRUCTIONS AND NOT USING THE PROVIDED HARDWARE MAY DAMAGE THE INTAKE TUBE, THROTTLE BODY AND ENGINE.**

**TO START:**

1. Turn off the ignition and disconnect the negative battery cable.  
**NOTE: Disconnecting the negative battery cable erases pre-programmed electronic memories. Write down all memory settings before disconnecting the negative battery cable. Some radios will require an anti-theft code to be entered after the battery is reconnected. The anti-theft code is typically supplied with your owner's manual. In the event your vehicles' anti-theft code cannot be recovered, contact an authorized dealership to obtain your vehicles anti-theft code.**



2. Loosen hose clamp at the air box, then remove intake tube from the air box as shown.



3. Lift firmly up on the air box to remove from car, then disconnect the crank case vent from the air box.



4. Loosen hose clamp at the turbo then remove the intake tube from the vehicle.



5. Disconnect the vacuum line from the intake tube as shown.  
**NOTE: K&N Engineering, Inc., recommends that customers do not discard factory air intake.**



6. Disconnect the crank case vent line from the valve cover as shown.

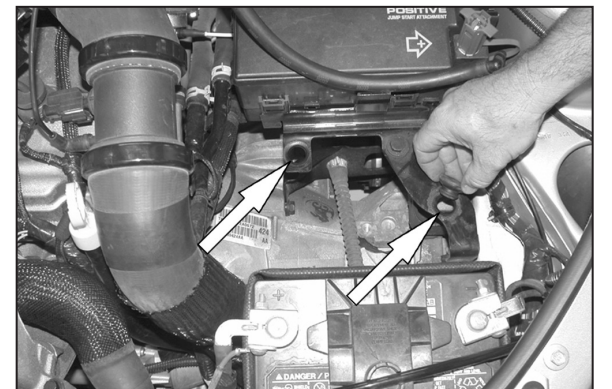

7. Remove the two air box grommets from the stock air box mounting tray.



8. Install the new bracket onto the cylinder head with the provided hardware.

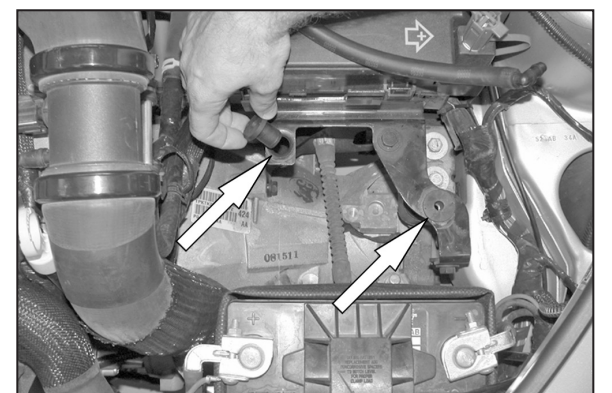

9. Install the two rubber nut inserts into air box grommet holes as shown.



10. Install the edge trim onto the heat shield as shown. Trim if needed.

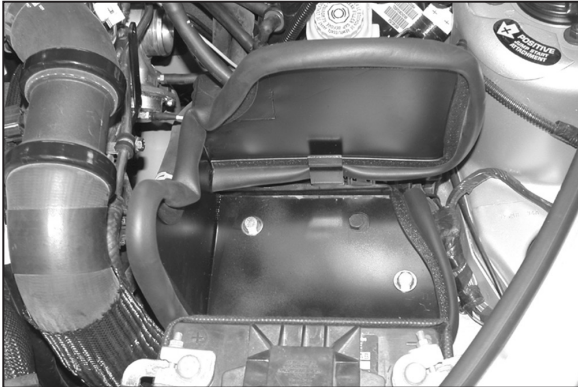

11. Install the heat shield onto the vehicle with the provided hardware as shown.

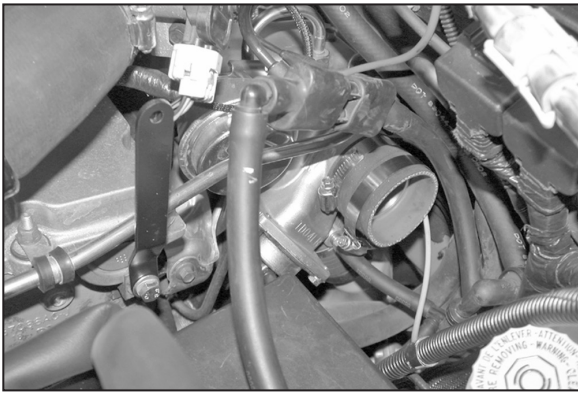

12. Install the provided silicone hose (08405) onto the turbo inlet as shown with the provided hose clamp.

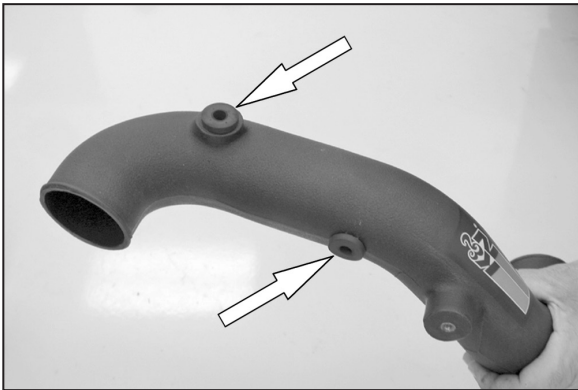

13. Install the two provided grommets onto the intake tube as shown.

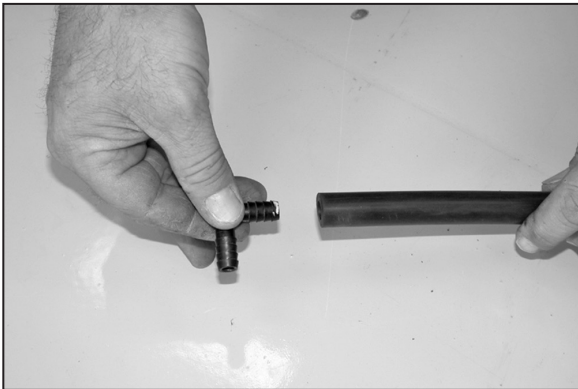

14. Install the 90 deg vent fitting onto the provided silicone hose as shown.



15. Connect the silicone hose with vent fitting on the valve cover as shown.

**NOTE: Fitting is under intercooler hose.**

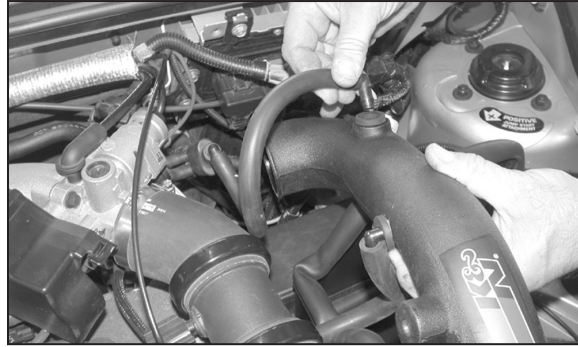

16. Reconnect the two vent fittings onto the new intake tube as shown.

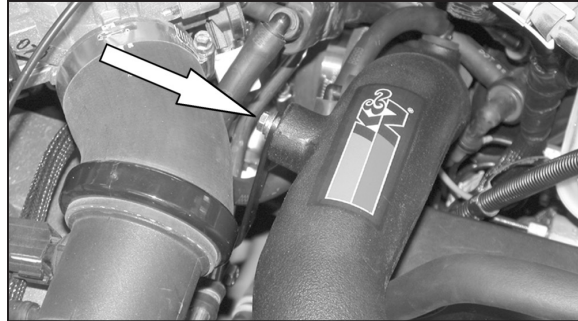

17. Connect the new intake tube onto the turbo inlet with the provided hose clamp. Then connect the intake tube to the bracket on the cylinder head as shown.



18. Install the filter adaptor onto the intake tube as shown.



19. Install the air filter onto the intake tube as shown.

**NOTE: Drycharger® air filter wrap; part # RP-4660DK is available to purchase separately. To learn more about Drycharger® filter wraps or look up color availability please visit <http://www.knfilters.com>®.**



20. Reconnect the vehicle's negative battery cable. Double check to make sure everything is tight and properly positioned before starting the vehicle.

21. The C.A.R.B. exemption sticker, (attached), must be visible under the hood so that an emissions inspector can see it when the vehicle is required to be tested for emissions. California requires testing every two years, other states may vary.

22. It will be necessary for all K&N® high flow intake systems to be checked periodically for realignment, clearance and tightening of all connections. Failure to follow the above instructions or proper maintenance may void warranty.

#### ROAD TESTING:

1. Start the engine with the transmission in neutral or park, and the parking brake engaged. Listen for air leaks or odd noises. For air leaks secure hoses and connections. For odd noises, find cause and repair before proceeding. This kit will function identically to the factory system except for being louder and much more responsive.

2. Test drive the vehicle. Listen for odd noises or rattles and fix as necessary.

3. If road test is fine, you can now enjoy the added power and performance from your kit.

4. K&N Engineering, Inc., requires cleaning the intake system's air filter element every 100,000 miles. When used in dusty or off-road environments, our filters will require cleaning more often. We recommend that you visually inspect your filter once every 25,000 miles to determine if the screen is still visible. When the screen is no longer visible some place on the filter element, it is time to clean it. To clean and re-oil, purchase our filter Recharger® service kit, part number 99-5050 or 99-5000 and follow the easy instructions.

**INTAKE SYSTEMS FOR VEHICLES LISTED ARE 50 STATE LEGAL. SEE KNFILTERS.COM FOR CARB STATUS ON EACH PART FOR A SPECIFIC VEHICLE.**