



TYPHOON INTAKE SYSTEMS

INTAKE SYSTEMS FOR VEHICLES LISTED ARE 50 STATE LEGAL. SEE KNFILTERS.COM FOR CARB STATUS ON EACH PART FOR A SPECIFIC VEHICLE.

INSTALLATION INSTRUCTIONS

69-5301TTK
HYUNDAI
2011-14 Sonata
L4-2.4L

TOOLS NEEDED:
Ratchet
Extension
10mm socket
9/16" wrench
10mm wrench
4mm allen
flat blade screwdriver
Phillips screwdriver
Pliers

NOTE: EXCLUDING SONATA HYBRID
NOTE: EXCLUDING LEV2 SULEV 2011-14 TEST GROUPS
BHYXV02.4YPC, BHYXV02.4ZS2, CHYXV02.4YPC
CHYXV02.4ZP2, DHYXV02.42GP, DHYXV02.4AHN
EHYXV02.42JP, EHYXV02.4AKN

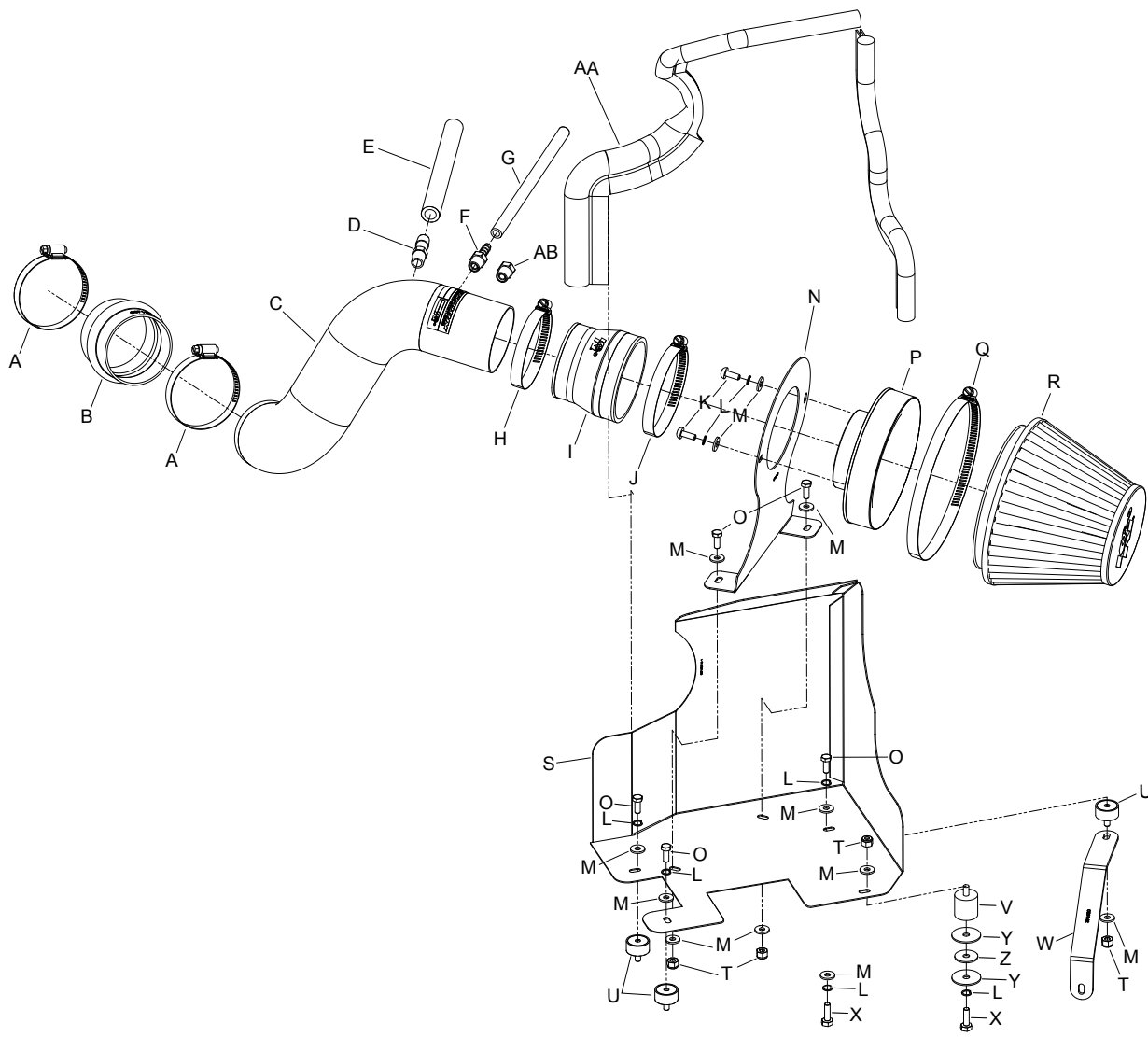

PARTS LIST		Qty.	Part #
Description			
A	Hose Clamp #44 Stainless	2	08560
B	Hose; 3" ID X 2-1/2" L Hump	1	087121
C	Intake Tube	1	27477
D	Vent; Strt. 1/2" Hose, 1/4"NPT	1	080022
E	Hose; 1/2" id X 7" L	1	08159
F	Vent; Strt, 5/16" Barbed, 1/4 NPT, Nylon	1	08908
G	Hose; 8mm ID X 8-1/4" L	1	08076
H	Hose Clamp #48	1	08601
I	Hose; 3-1/2" To 3" ID X 3" L TPRD Molded	1	08724
J	Hose Clamp #56	1	08620
K	Bolt; M6 X 1.00 X 16mm , Buttonhead, SS	2	07730
L	Washer; 1/4" Lock, ZN	7	08198
M	Washer; 1/4" id X 5/8" OD - SAE	12	08275
N	Bracket; Mild Stl., TB/PC	1	074073
O	Bolt; 6mm-1.00 X 16mm, SS	5	07812
P	Adapter; Universal, 6" Filter 3.5" Coupler	1	21512-1
Q	Hose Clamp #104	1	08697
R	Air Filter	1	RC-5138
S	Heat Shield	1	074074-1
T	Nut; 6mm Nylock, Hexhead, SS	4	07512
U	Stud; Rubber Mnt, M/F, 1/2"L X 1"W	3	070228
V	Stud; Rubber Mounted, M6 X 1, 1" T, M/F	1	02033
W	Bracket; "C", Stl., TB/PC	1	083142
X	Bolt; M6 X 1.00" X 20mm Hex, SS	2	07795
Y	Washer; 1.25d X .28	2	08151
Z	Washer; 1" X .300 X .100 Rubber	1	21685
AA	Edge Trim (39")	1	102496
AB	Plug	1	08032

If you need any assistance please call 1-800-858-3333 to speak with a representative in our Customer Service Center before returning the product.

NOTE: FAILURE TO FOLLOW INSTALLATION INSTRUCTIONS AND NOT USING THE PROVIDED HARDWARE MAY DAMAGE THE INTAKE TUBE, THROTTLE BODY AND ENGINE.

TO START:

1. Turn off the ignition and disconnect the negative battery cable.
NOTE: Disconnecting the negative battery cable erases pre-programmed electronic memories. Write down all memory settings before disconnecting the negative battery cable. Some radios will require an anti-theft code to be entered after the battery is reconnected. The anti-theft code is typically supplied with your owner's manual. In the event your vehicles' anti-theft code cannot be recovered, contact an authorized dealership to obtain your vehicles anti-theft code.



2. Lift up the engine cover to dislodge it from the mounting grommets, remove the engine cover from the vehicle.



3. Release the spring clamp that secures the crankcase vent hose to the valve cover and the disconnect the crankcase vent hose from the valve cover.



4. On vehicles equipped with an EVAP vent line, disconnect the EVAP hose from the purge valve.



5. Loosen the hose clamp securing the intake tube to the throttle body, then disconnect the intake tube from the throttle body.



6. Remove the two screws securing the fresh air duct to the core support.



7. Remove the fresh air duct from the vehicle.



8. Remove the two bolts that secure the airbox.



9. Remove the airbox assembly from the vehicle.
NOTE: K&N Engineering, Inc., recommends that customers do not discard factory air intake.



10. Remove the airbox mounting grommet shown.

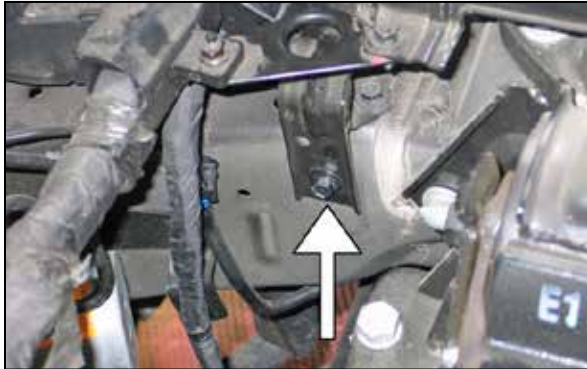

11. Remove the airbox mounting bracket bolt shown.



12. Install one of the provided rubber mounted studs onto the heat shield mounting bracket as shown using the provided hardware.



13. Install the heat shield mounting bracket assembly onto the airbox mounting bracket and secure using the provided hardware.



14. Install the provided large rubber mounted stud onto the airbox mounting grommet location using the provided hardware.



15. Install the two remaining rubber mounted studs onto the airbox mounting locations as shown.

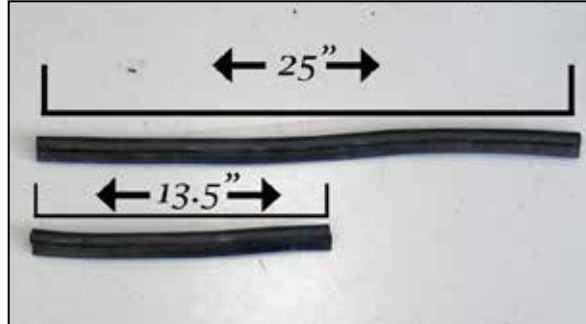

16. Cut the provided edge trim into two sections as shown. One section should be 13.5" and the other section should be 25" long.

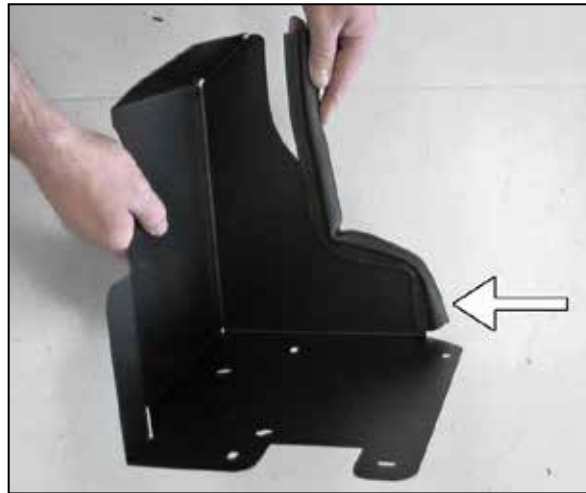

17. Install the shorter 13.5" section onto the heat shield as shown.



18. Install the longer 25" section onto the heat shield as shown.

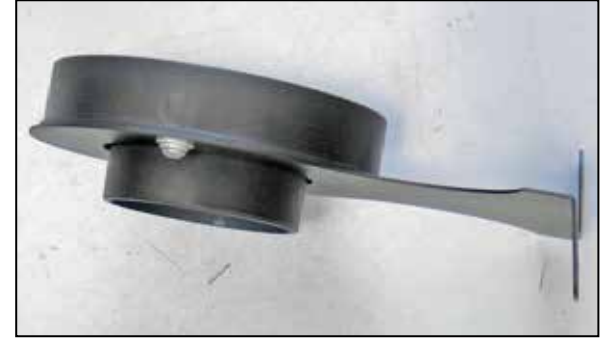

19. Install the filter adapter onto the mounting bracket as shown using the provided hardware.
NOTE: The radius adapter will cover over the bracket part number when properly installed.



20. Install the bracket assembly onto the heat shield as shown using the provided hardware.
NOTE: Do not completely tighten at this time.



21. Set the heat shield assembly onto the rubber mounted studs and secure with the provided hardware.



22. Install the provided silicone hose (08724) onto the filter adapter and secure with the provided hose clamps.

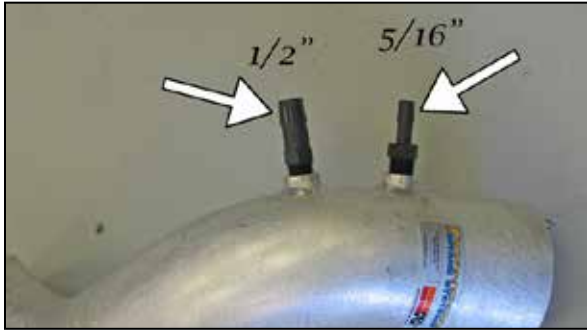

23. Install the two provided vent fittings into the K&N® intake tube as shown.

NOTE: ON vehicles not equipped with an EVAP vent line, install the npt plug in place of the 5/16" vent fitting.

NOTE: Plastic NPT fittings are easy to cross thread. Install the vent fitting "hand" tight, then turn it two complete turns with a wrench.



24. Install the provided silicone hose (087121) onto the K&N® intake tube and secure with the provided hose clamp.



25. Install the K&N® intake tube assembly onto the throttle body and into the silicone hose on the filter adapter, then secure with the provided hose clamps. Tighten the hardware securing the mounting bracket to the heat shield.



26. On vehicles equipped with an EVAP vent line, Install the provided EVAP hose onto the purge valve and then connect the other end to the vent fitting installed into the intake tube.

NOTE: Some trimming of the hose may be necessary.



27. Install the provided crankcase vent hose onto the valve cover port and then connect the other end to the vent fitting installed into the intake tube.

NOTE: Some trimming of the hose may be necessary.



28. Install the K&N® air filter onto the filter adapter and secure with the provided hose clamp.

NOTE: Drycharger® air filter wrap; part # 22-8049DK is available to purchase separately. To learn more about Drycharger® filter wraps or look up color availability please visit <http://www.knfilters.com>®.



29. Install the engine cover.



30. Install the fresh air duct and secure with the factory retaining screws.



31. Reconnect the vehicle's negative battery cable. Double check to make sure everything is tight and properly positioned before starting the vehicle.

32. The C.A.R.B. exemption sticker, (attached), must be visible under the hood so that an emissions inspector can see it when the vehicle is required to be tested for emissions. California requires testing every two years, other states may vary.

33. It will be necessary for all K&N® high flow intake systems to be checked periodically for realignment, clearance and tightening of all connections. Failure to follow the above instructions or proper maintenance may void warranty.

ROAD TESTING:

1. Start the engine with the transmission in neutral or park, and the parking brake engaged. Listen for air leaks or odd noises. For air leaks secure hoses and connections. For odd noises, find cause and repair before proceeding. This kit will function identically to the factory system except for being louder and much more responsive.

2. Test drive the vehicle. Listen for odd noises or rattles and fix as necessary.

3. If road test is fine, you can now enjoy the added power and performance from your kit.

4. K&N Engineering, Inc., requires cleaning the intake system's air filter element every 100,000 miles. When used in dusty or off-road environments, our filters will require cleaning more often. We recommend that you visually inspect your filter once every 25,000 miles to determine if the screen is still visible. When the screen is no longer visible some place on the filter element, it is time to clean it. To clean and re-oil, purchase our filter Recharger® service kit, part number 99-5050 or 99-5000 and follow the easy instructions.

INTAKE SYSTEMS FOR VEHICLES LISTED ARE 50 STATE LEGAL. SEE KNFILTERS.COM FOR CARB STATUS ON EACH PART FOR A SPECIFIC VEHICLE.