

advanced FLOW engineering Track Series Cold Air Intake System

Instruction Manual P/N: 57-10004D / 57-10004R

Make: BMW	Model: M2 (F87)	Year: 2016-2018	Engine: L6-3.0L (t) N55
Make: BMW	Model: 335i/xi (F30/34)	Year: 2012-2015	Engine: L6-3.0L (t) N55
Make: BMW	Model: 435i/xi (F32/33/36)	Year: 2014-2016	Engine: L6-3.0L (t) N55
Make: BMW	Model: M135i/xi/M235i (F20/21/22)	Year: 2012-2016	Engine: L6-3.0L (t) N55



- Please read the entire instruction manual before proceeding.
- Ensure all components listed are present.
- For technical support please call at 951-493-7185.
- Ensure you have all necessary tools before proceeding.
- Do not attempt to work on your vehicle when the engine is hot.
- Retain factory parts for future use.

Label	Qty.	Description	Part Number
A1	1	Air Filter (Pro DRY S)	21-90113
A2	1	Air Filter (Pro 5R)	24-90113
B	1	Tube, Carbon Fiber	05-82202C1
C	1	Housing, Plastic	05-5710004B1
D	2	Screw, M4	03-50490
E	1	Trim Seal: 3/4" Bulb (38")	05-01507
F	1	Cap, Vinyl: 3/4" ID	03-50035
G	1	Torx Bit: M4	03-50066

Installation will require the following tools:

6mm, 8mm, and 13mm nut drivers or sockets, socket wrench, flat-head screwdriver, and pliers.

Emissions Disclaimer: This product is not currently CARB exempt and is not available for purchase in California or for use on any vehicle registered with the California Department of Motor Vehicles.

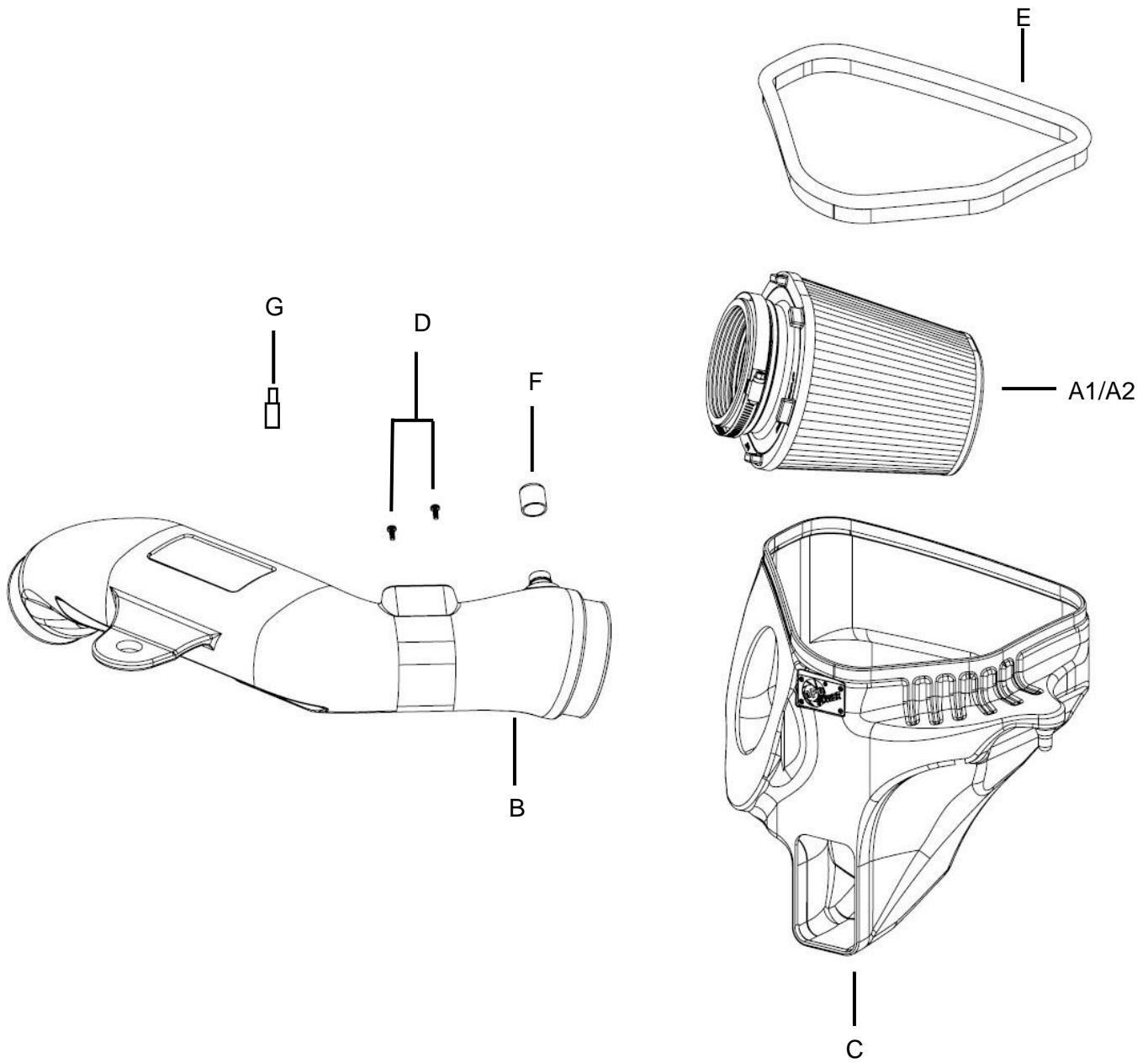

**Figure A****Refer to Figure A for Step 1**

Step 1: If your vehicle is equipped with a brace, remove the brace by unscrewing the four (4) 13mm bolts.

Keep the bolts for later use ①.

Figure B

Refer to Figure B for Steps 2-5

Step 2: Disconnect the MAF sensor harness ②.

Step 3: If equipped, unplug the vacuum line from the factory intake ③.

Step 4: Using a 6mm nut driver, loosen the hose clamp at the factory intake ④. Then, slide the factory intake away from the turbo inlet pipe.

Step 5: To remove the factory intake, carefully pull up and away from the engine bay.

**Figure C****Refer to Figure C for Steps 6-8**

Step 6: Transfer the MAF sensor from the factory intake to the aFe Power intake tube and attach with the supplied screws (5) and Torx bit.

Step 7: Remove the factory grommet on top of the radiator support and install it onto the aFe Power intake tube (6).

Step 8: For vehicles with the manual transmission, cap off the aluminum fitting with the provided vinyl cap (7).

**Figure D****Refer to Figure D for Steps 9-10**

Step 9: Remove the clamp from the supplied aFe POWER air filter's flange. Slide the air filter into the aFe POWER housing from the top opening. Then, guide the air filter flange through the round opening in the housing and snap in the air filter. Place the clamp back on the air filter flange, but do not tighten at this time. Make sure to rotate the air filter to have the wider side face up (8).

Step 10: Install the provided trim seal along the top edge of the aFe Power housing (9).



Figure E

Refer to Figure E for Step 11

Step 11: Install the assembled aFe Power housing with air filter into the engine bay.



Refer to Figure F for Steps 12-17

Step 12: Install the aFe Power intake tube into the turbo inlet, then into the air filter, then onto the peg on the radiator support. Do not tighten the clamps at this time.

Step 13: For vehicles with a CCV hose, connect the CCV hose to the aFe power intake tube ⑩.

Step 14: Connect the MAF harness to the MAF sensor ⑪.

Step 15: Make sure all parts sit correctly in the vehicle, then tighten all of the clamps.

Step 16: If your vehicle is equipped with a brace, re-install the brace with the factory bolts from Step 1.

Step 17: Verify all clamps are secure and re-check periodically. Your installation is now complete. Thank you for choosing aFe Power!

Pro DRY S Air Filter



P/N: 21-90113

Pro 5R Air Filter



P/N: 24-90113

Pre-Filter



P/N: 28-10153

Pro DRY S Restore Kit



P/N: 90-59999

Pro DRY S Restore Kit



P/N: 90-50501

SPRINT BOOSTER V3



P/N: 77-16302

Cat-Back Exhaust



P/N: 49-36330-P

Down Pipe



P/N: 49-36315-HC

Intercooler



P/N: 46-20272-B

Throttle Body Spacer



P/N: 46-31007

Lowering Springs

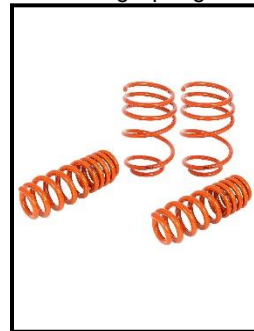

P/N: 410-503001-N

Oil Filters



P/N: 44-LF029

To purchase any of the items above, view airflow charts, dyno graphs, photos, and video; please go to aFepower.com.



Warranty

General Terms:

- aFe warrants their products to be free from manufacturer's defects due to workmanship and material.
- This warranty applies only to the original purchaser of the product and is non-transferrable.
- Proof of purchase of the aFe product is required for all warranty claims.
- Warranty is valid provided aFe instructions for installation and/or cleaning were properly followed.
- Proper maintenance with regular inspections of product is required to insure warranty coverage.
- Damage due to improper installation, abuse, unauthorized repair or alteration is not warranted.
- Incidental or consequential damages or cost, including installation and removal of part, incurred due to failure of aFe product is not covered under this warranty.
- All warranty is limited to the repair and/or replacement of the aFe part. To request Return Goods Authorization ("RGA"), email RGA@afepower.com or call (951)493-7100. Upon receipt of the RGA, you must return the product to the address provided in the RGA, freight prepaid and accompanied with a dated proof of purchase and the RGA. Upon receipt of the defective product and upon verification of proof of purchase, aFe will either repair or replace the defective product within a reasonable time, not to exceed thirty days.

Product Category	P/N Prefix	Warranty duration
Direct OE Replacement Filters	10, 11, 30, 31, 71, 73	Life of the vehicle
Racing Filters	18	1 year
Universal	20, 21, 23, 24, 72, TF	2 years
Air Intake Systems	50, 51, 53, 54, 55, 56, 57, 58, 75, TR, TA, TL, TM	2 years
Exhaust Systems	49	2 years
Intercoolers & Intercooler Tubes	46-2	2 years
Intake Manifolds	46-1	2 years
Differential Cover	46-7	Life of the vehicle
Exhaust Manifolds	46	2 years
Throttle Body Spacers	46-3	2 years
Turbochargers	46-6	2 years*
Fluid Filters	44	90 days
Pre-Filters	28	2 years
Heavy Duty OE Replacement	70	2 years
PowerSports OE Replacement	81, 87	2 years
PowerSports Intake Systems	85	2 years

No other warranty expressed or implied applies nor is any person or advanced FLOW engineering authorized to assume any other warranty. Some States do not allow the exclusion or limitation of incidental or consequential damages or do not allow limitations on how long an implied warranty lasts, so the above limitations or exclusions may not apply to you. This warranty gives you specific legal rights, and you may also have other rights which vary from State to State.

*See turbocharger warranty for more info



advanced FLOW engineering, inc.

252 Granite Street Corona, CA 92879
TEL: 951.493.7100 • TECH: 951.493.7185
E-Mail: Tech@aFepower.com

P/N: 06-81274