



AIRCHARGER®

HIGH-FLOW INTAKE KITS

NOT LEGAL FOR SALE OR USE ON ANY POLLUTION CONTROLLED MOTOR VEHICLE IN CALIFORNIA OR STATES ADOPTING CALIFORNIA EMISSION PROCEDURES.
See knfilters.com for CARB status on each part for a specific vehicle

INSTALLATION INSTRUCTIONS

63-3517
HONDA
2016-19 Civic
L4-2.0L

TOOLS NEEDED:

- flat blade screw driver
- phillips screw driver
- ratchet
- extension
- 10mm socket
- 3mm hex key
- 4mm hex key
- pliers.

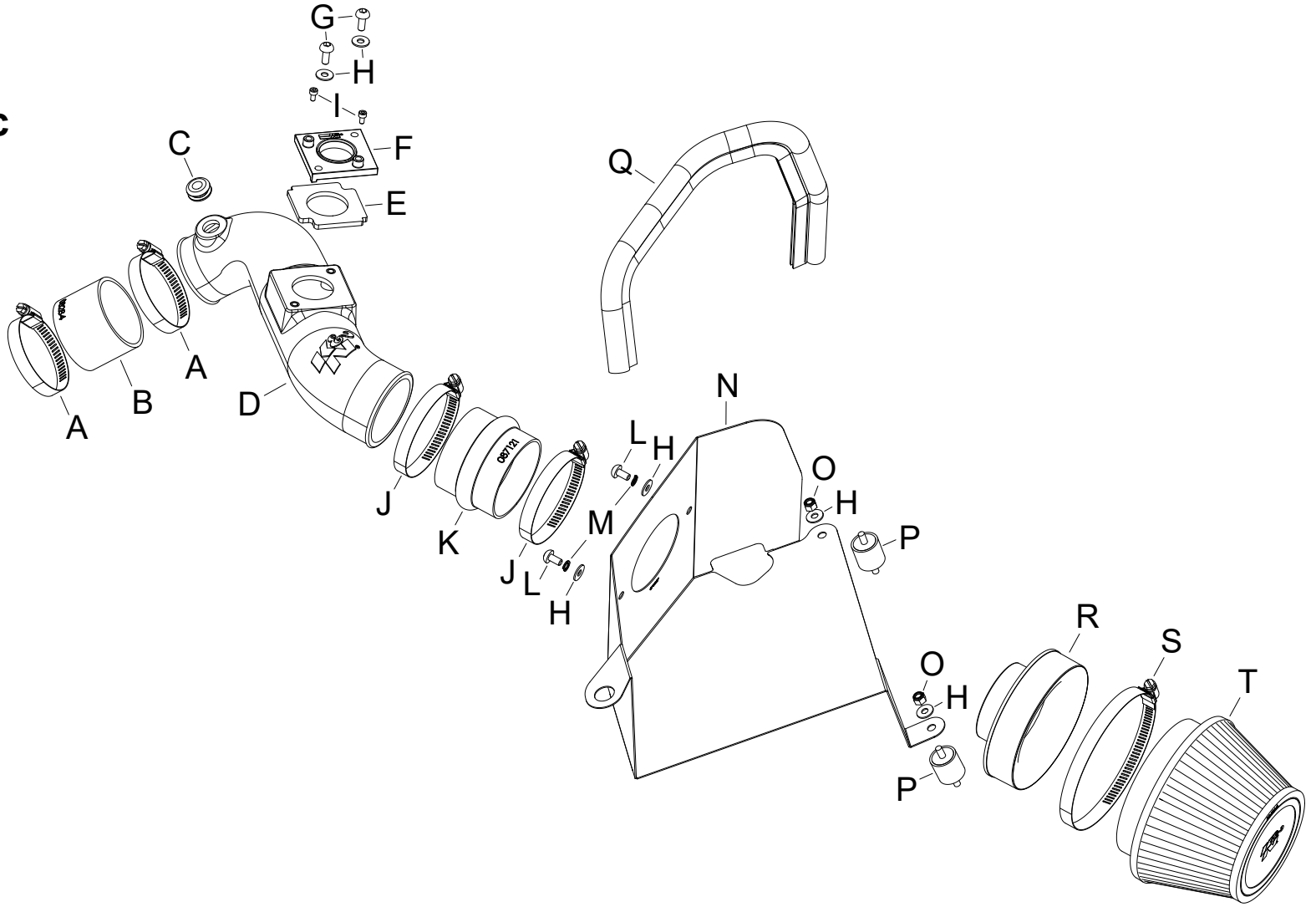

PARTS LIST:

Description	Qty.	Part #	Description	Qty.	Part #	Description	Qty.	Part #
A HOSE CLAMP #40	2	08554	H WASHER; 6MM FLAT, SS	6	08269	O NUT; 6MM NYLOCK, HEXHEAD,	2	07512
B HOSE; 2-1/2" ID X 2" L REIN	1	08284	I BOLT; M4 - 0.7 8MM, A/H CAP	2	07733	P MOUNT, RUBBER 1" X 6MM	2	1228599
C GROMMET; 7/8"OD, 3/8"ID	1	784638	J HOSE CLAMP #48	2	08601	Q EDGE TRIM (20")	1	102494
D INTAKE TUBE	1	087334A	K HOSE; 3" ID X 2-1/2" L HUMP	1	087121	R ADAPTER; FILTER, 3.0"OD	1	21569
E GASKET; 57-1003, 3/16 PORON	1	09074	L BOLT; M6 X 1.00" 12MM, SS	2	07794	S HOSE CLAMP #80	1	08694
F ADAPTER; 63-9039, MASS AIR	1	088048	M WASHER, M6 SPLIT LOCK ZINC	2	1-3025	T FILTER CHARGER	1	RU-5163XD
G BOLT; M6 X 1.00 X 16MM, SS	2	07730	N HEAT SHIELD	1	073237			

If you need any assistance please call 1-800-858-3333 to speak with a representative in our Customer Service Center before returning the product.

NOTE: FAILURE TO FOLLOW INSTALLATION INSTRUCTIONS AND NOT USING THE PROVIDED HARDWARE MAY DAMAGE THE INTAKE TUBE, THROTTLE BODY AND ENGINE.

TO START:

1. Turn off the ignition and disconnect the negative battery cable.
NOTE: Disconnecting the negative battery cable erases pre-programmed electronic memories. Write down all memory settings before disconnecting the negative battery cable. Some radios will require an anti-theft code to be entered after the battery is reconnected. The anti-theft code is typically supplied with your owner's manual. In the event your vehicles anti-theft code cannot be recovered, contact an authorized dealership to obtain your vehicles anti-theft code.



2. Remove the nine clips that secure the core support cover and then remove the cover from the vehicle.

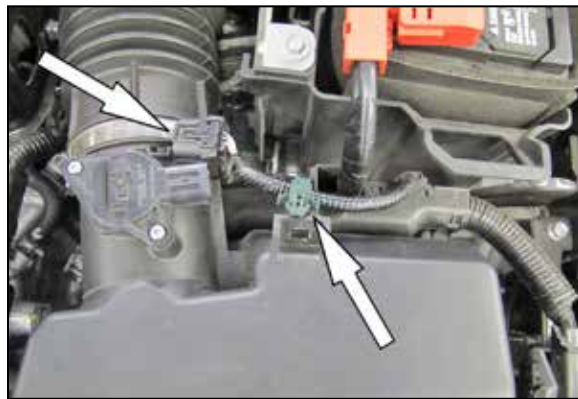

3. Disconnect the mass air sensor connection and unhook the harness from the air filter housing.



4. Remove the two plastic clips that secure the intake air diverter and then lift off the air diverter.



5. Loosen the two hose clamps that secure the intake tube to the air filter housing and the throttle body, Loosen the spring clamp securing the crank case vent hose and then remove the intake hose from the vehicle.



6. Loosen the two bolts that secure the air filter housing, apply some spray lubricant to the mounting grommet and then remove the air filter housing from the vehicle.
NOTE: K&N Engineering, Inc., recommends that customers do not discard factory air intake.

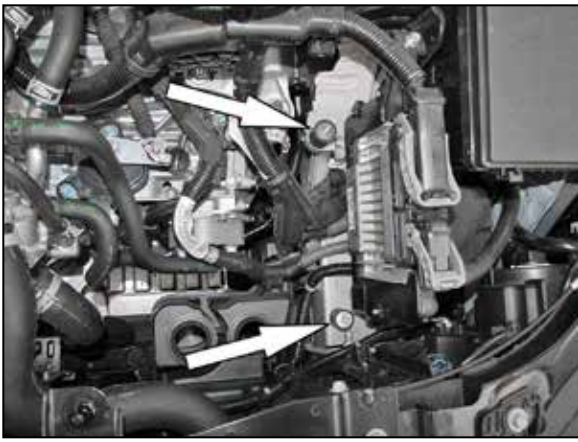

7. Install the two provided rubber mounted studs onto the air filter housing mounting locations as shown.



8. Install the filter adapter into the heat shield as shown and secure with the provided hardware.

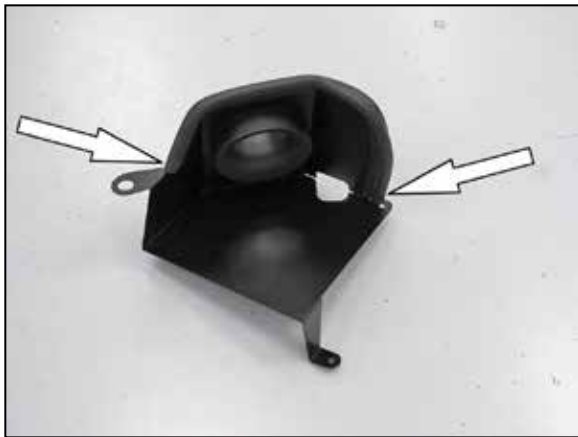

9. Install the provided edge trim onto the heat shield as shown.

NOTE: Some trimming of the edge trim will be necessary.



10. Remove the mounting grommet from the factory air filter housing and install it into the K&N® heat shield as shown.



11. Install the heat shield assembly into the vehicle and secure with the provided hardware and factory grommet.



12. Install the K&N® air filter onto the filter adapter and secure with the provided hose clamp.

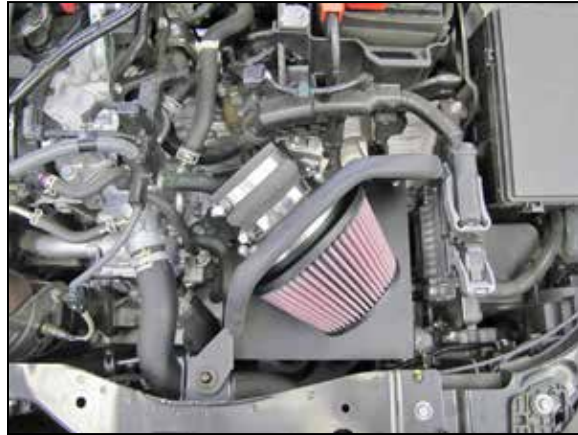

13. Install the coupling hose (087121) onto the filter adapter and secure with the provided hose clamp.



14. Install the coupling hose (08284) onto the throttle body and secure with the provided hose clamp.



15. Install the provided gasket onto the K&N® mass air sensor adapter as shown.



16. Remove the mass air sensor from the factory air filter housing.



17. Install the mass air sensor into the K&N® mass air adapter and secure with the provided hardware.



18. Install the mass air sensor assembly into the K&N® intake tube as shown and secure with the provided hardware. Install the crank case vent grommet into the K&N® intake tube as shown. **NOTE: The arrow on the top of the sensor indicates the direction of air flow when the sensor is installed correctly.**



19. Install the K&N® intake tube into the coupling hoses, adjust for best fit and then secure with the provided hose clamps.



20. Install the crank case vent tube into the grommet installed into the K&N® intake tube.



21. Reconnect the mass air sensor electrical connection.



22. Reinstall the core support cover and secure with the factory retaining clips.



23. Reconnect the vehicle's negative battery cable. Double check to make sure everything is tight and properly positioned before starting the vehicle.

24. It will be necessary for all K&N® high flow intake systems to be checked periodically for realignment, clearance and tightening of all connections. Failure to follow the above instructions or proper maintenance may void warranty.

ROAD TESTING:

1. Start the engine with the transmission in neutral or park, and the parking brake engaged. Listen for air leaks or odd noises. For air leaks secure hoses and connections. For odd noises, find cause and repair before proceeding. This kit will function identically to the factory system except for being louder and much more responsive.

2. Test drive the vehicle. Listen for odd noises or rattles and fix as necessary.

3. If road test is fine, you can now enjoy the added power and performance from your kit.

4. K&N Engineering, Inc., requires cleaning the intake system's air filter element every 100,000 miles. When used in dusty or off-road environments, our filters will require cleaning more often. We recommend that you visually inspect your filter once every 25,000 miles to determine if the screen is still visible. When the screen is no longer visible some place on the filter element, it is time to clean it. To clean and re-oil, purchase our filter Recharger® service kit, part number 99-5050 or 99-5000 and follow the easy instructions.

NOT LEGAL FOR SALE OR USE ON ANY POLLUTION CONTROLLED MOTOR VEHICLE IN CALIFORNIA OR STATES ADOPTING CALIFORNIA EMISSION PROCEDURES.

See knfilters.com for CARB status on each part for a specific vehicle